

Fixing Dimensions Drawing Steel Drag Link of Model TL115

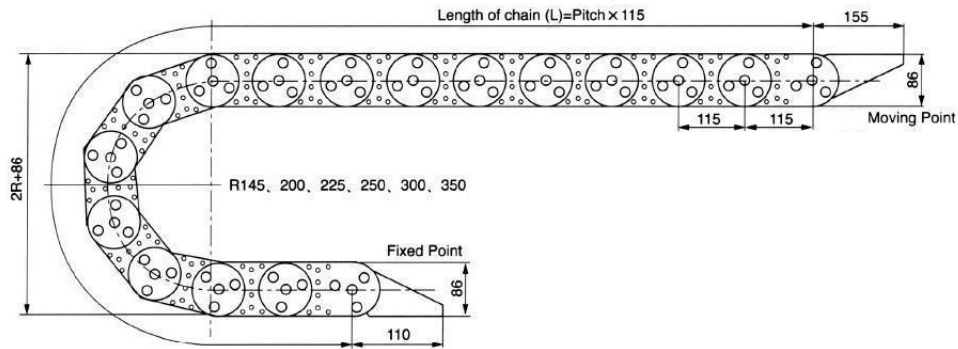

I Integral type
II Separate type

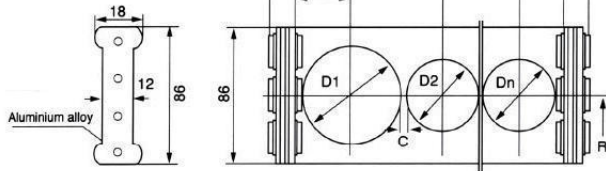

Supporting board I Integral type, II Separate type

III Frame type

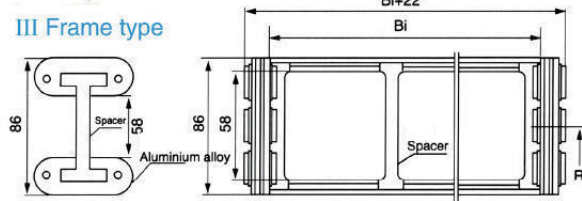

Supporting board III, Frame type

Standard connection

Standard connection

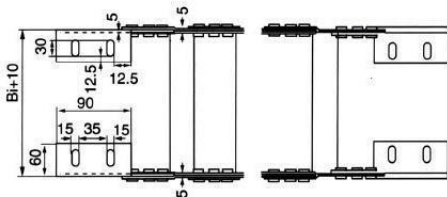

Manner of connection A

Manner of connection B

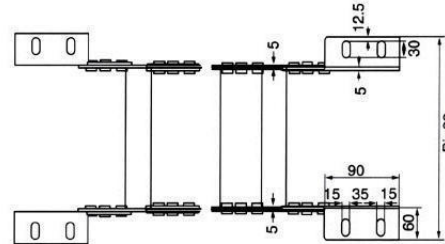

Legends

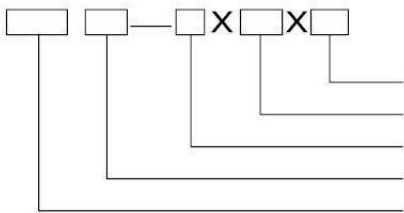

- L=length of drag chains
- Bi=width of supporting board of drag chain
- Bending radius
- Supporting Board Type I, II, III
- Model No.

Example for an order

Drag chain model number TL115, supporting board III type, bend radius R=250, supporting board width Bi=300 length L=7500
 Drag chain TL115 III -250 x 300 x 7500
 I-type integral type of support board
 II-type separate type of support board
 III-type the upper one and the lower one are made of aluminium with spacer inside